

Raccordi accessori Sprint® Serie S2000

Filetti dei raccordi: cilindrici (G1/8, G1/4, G3/8, G1/2),
conici (R1/8, R1/4, R3/8, R1/2)



I raccordi accessori Serie S2000 sono caratterizzati da una grande affidabilità dei filetti femmina, sia cilindrici che conici, con superfici non piane. I modelli Sprint sono dotati di un particolare sistema di tenuta, già alloggiato sul filetto conico, che rende superfluo l'uso di collanti liquidi o del nastro PTFE ottimizzando la fase di montaggio.

Grazie a questo sistema di tenuta è possibile montare e smontare più volte il raccordo senza pregiudicare la tenuta sul filetto.

CARATTERISTICHE GENERALI

Materiale	OT nichelato e PTFE
Filettature	GAS conico ISO 7 (BSPT) GAS cilindrico ISO 228 (BSP)
Pressione	40 bar
Fluido	Aria compressa ed altri fluidi a bassa pressione.
Temperatura	-40°C + 120°C

Raccordi Accessori Sprint®

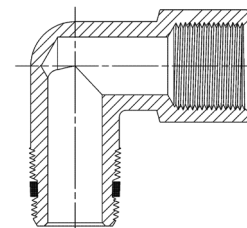

Raccordi Mod. S2500

Niplo Conico Sprint®

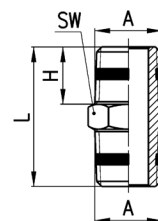
DIMENSIONI

Mod.	A	H	L	SW	Peso (g)
S2500 1/8	R1/8	7,5	19,5	12	8
S2500 1/4	R1/4	11	27	14	15
S2500 3/8	R3/8	11,5	28	17	21
S2500 1/2	R1/2	14	33,5	22	39

Raccordi Mod. S2530

Niplo Ridotto Conico Sprint®

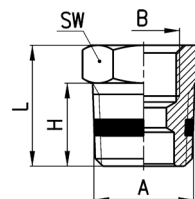
DIMENSIONI

Mod.	A	B	H	L	SW	Peso (g)
S2530 1/4-1/8	R1/4	G1/8	11	16	14	9
S2530 3/8-1/8	R3/8	G1/8	11,5	16,5	17	16
S2530 1/2-1/8	R1/2	G1/8	14	19,5	22	13
S2530 3/8-1/4	R3/8	G1/4	11,5	16,5	17	33
S2530 1/2-1/4	R1/2	G1/4	14	19,5	22	32
S2530 1/2-3/8	R1/2	G3/8	14	19,5	22	22

Raccordi Mod. S2520

Prolunga Riduzione Maschio Conica Sprint®

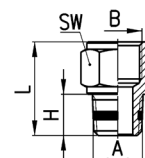
DIMENSIONI

Mod.	A	B	H	L	SW	Peso (g)
S2520 1/8-1/8	R1/8	G1/8	7,5	17,5	13	11
S2520 1/8-1/4	R1/8	G1/4	7,5	19	17	15
S2520 1/8-3/8	R1/8	G3/8	7,5	20	20	19
S2520 1/4-1/4	R1/4	G1/4	11	22,5	17	17
S2520 1/4-3/8	R1/4	G3/8	11	23,5	20	33
S2520 1/4-1/2	R1/4	G1/2	11	27,5	24	34
S2520 3/8-3/8	R3/8	G3/8	11,5	24	20	36
S2520 3/8-1/2	R3/8	G1/2	11,5	28	24	56
S2520 1/2-1/2	R1/2	G1/2	14	30,5	24	41

Raccordi Mod. S2510

Riduzione Conica Sprint®

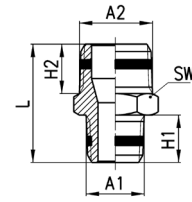

DIMENSIONI							
Mod.	A1	A2	H1	H2	L	SW	Peso (g)
S2510 1/8-1/4	R1/8	R1/4	7,5	11	23,5	14	14
S2510 1/8-3/8	R1/8	R3/8	7,5	11,5	24	17	22
S2510 1/4-3/8	R1/4	R3/8	11	11,5	27,5	17	19
S2510 1/4-1/2	R1/4	R1/2	11	14	30,5	22	33
S2510 3/8-1/2	R3/8	R1/2	11,5	14	31	22	36

Raccordi Mod. 2541

Nipplo Maschio Girevole Cilindrico Sprint®

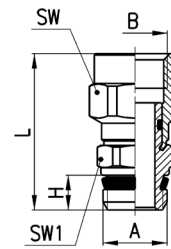

DIMENSIONI							
Mod.	A	B	H	L	SW	SW1	Peso (g)
2541 1/8-1/8	G1/8	G1/8	5,5	28	13	14	17
2541 1/4-1/4	G1/4	G1/4	7	31,5	17	14	26
2541 3/8-3/8	G3/8	G3/8	8	34	20	19	39

Raccordi Mod. S2010

Gomito Maschio Conico Sprint®

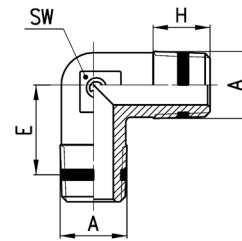

DIMENSIONI					
Mod.	A	E	H	SW	Peso (g)
S2010 1/8	R1/8	11,5	7,5	9	9
S2010 1/4	R1/4	13,5	11	12	17
S2010 3/8	R3/8	15,5	11,5	14	25
S2010 1/2	R1/2	16	14	16	47

Raccordi Mod. S2020

Gomito Femmina Maschio Sprint®

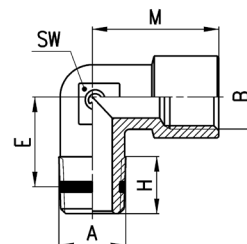

DIMENSIONI							
Mod.	A	B	E	H	M	SW	Peso (g)
S2020 1/8-1/8	R1/8	G1/8	11,5	8,5	19	11	16
S2020 1/4-1/4	R1/4	G1/4	15	11	23	13	27
S2020 3/8-3/8	R3/8	G3/8	15	11,5	25	15	33
S2020 1/2-1/2	R1/2	G1/2	17,5	14	31,5	20	62

Raccordi Mod. S2050

T.M.M.F. Sprint®

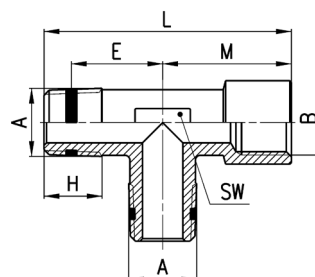
DIMENSIONI

Mod.	A	B	E	H	L	M	SW	Peso (g)
S2050 1/8-1/8	R1/8	G1/8	11,5	8,5	37	19	12	14
S2050 1/4-1/4	R1/4	G1/4	15	11	46	23	13	44
S2050 3/8-3/8	R3/8	G3/8	15	11,5	48,5	25	16	59
S2050 1/2-1/2	R1/2	G1/2	17,5	14	60,5	31,5	20	81

Raccordi Mod. S2060

T.F.M.F. Sprint®

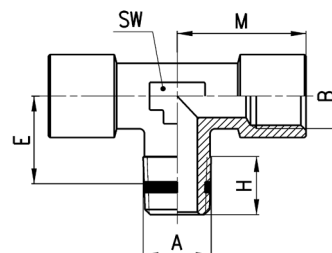
DIMENSIONI

Mod.	A	B	E	H	M	SW	Peso (g)
S2060 1/8-1/8	R1/8	G1/8	11,5	8,5	19	12	31
S2060 1/4-1/4	R1/4	G1/4	15	11	23	13	38
S2060 3/8-3/8	R3/8	G3/8	15	11,5	25	16	51
S2060 1/2-1/2	R1/2	G1/2	17,5	14	31,5	20	88

Raccordi Mod. S2070

T.M.F.F. Sprint®

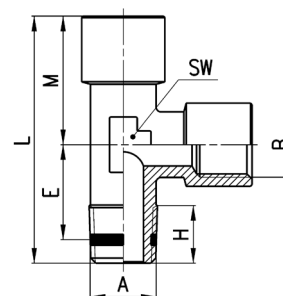
DIMENSIONI

Mod.	A	B	E	H	L	M	SW	Peso (g)
S2070 1/8-1/8	R1/8	G1/8	11,5	8,5	37	19	12	30
S2070 1/4-1/4	R1/4	G1/4	15	11	46	23	13	36
S2070 3/8-3/8	R3/8	G3/8	15	11,5	48,5	25	16	51
S2070 1/2-1/2	R1/2	G1/2	17,5	14	60,5	31,5	20	89

Raccordi Mod. S2080

T Maschio Sprint®

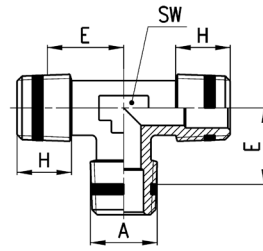

DIMENSIONI						
Mod.	A	E	H	SW	Peso (g)	
S2080 1/8	R1/8	11,5	7,5	9	14	
S2080 1/4	R1/4	13,5	11	12	31	
S2080 3/8	R3/8	15,5	11,5	14	50	
S2080 1/2	R1/2	16	14	16	63	

Raccordi Mod. S2090

T.M.F.M. Sprint®

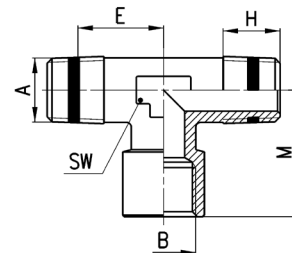

DIMENSIONI							
Mod.	A	B	E	H	M	SW	Peso (g)
S2090 1/8-1/8	R1/8	G1/8	11,5	8,5	19	12	22
S2090 1/4-1/4	R1/4	G1/4	15	11	23	13	16
S2090 3/8-3/8	R3/8	G3/8	15	11,5	25	16	59
S2090 1/2-1/2	R1/2	G1/2	17,5	14	31,5	20	80

Raccordi Mod. 2612 M7 e Mod. S2610

Mod. 2612 M7: Tappo Maschio Metrico
Mod. S2610: Tappo Maschio Cilindrico Sprint®

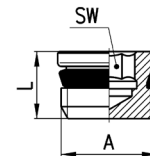

DIMENSIONI				
Mod.	A	L	SW	Peso (g)
2612 M7	M7	7	4	2
S2610 1/8	G1/8	7,5	4	3
S2610 1/4	G1/4	9	6	6
S2610 3/8	G3/8	10	8	12
S2610 1/2	G1/2	11	10	21

* con O-ring

Raccordi Mod. S2615

Tappo Maschio a scomparsa
Conico Sprint®

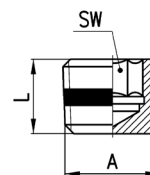

DIMENSIONI				
Mod.	A	L	SW	Peso (g)
S2615 1/8	R1/8	8	5	2
S2615 1/4	R1/4	10	7	6
S2615 3/8	R3/8	10	8	12

Raccordi accessori Serie 2000

Filetti dei raccordi: metrici (M5), cilindrici (G1/8, G1/4, G3/8, G1/2, G3/4, G1), conici (R1/8, R1/4, R3/8, R1/2, R3/4, R1)



L'ampia gamma di raccordi accessori Serie 2000 comprende giunzioni diritte, a L, a T, a croce, maschio o femmina e garantisce il supporto necessario alla progettazione di impianti per aria compressa.

4

COLLEGAMENTO

CARATTERISTICHE GENERALI

Materiale	OT nichelato
Filettature	GAS conico ISO 7 (BSPT) GAS cilindrico ISO 228 (BSP)
Pressione	40 bar
Fluido	Aria compressa ed altri fluidi a bassa pressione.
Temperatura	-40°C + 120°C

Raccordi accessori

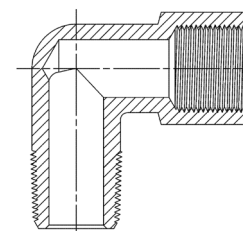

Raccordi Mod. 2500

Niplo Conico

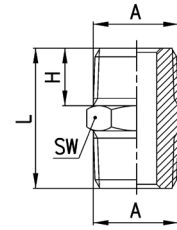

DIMENSIONI

Mod.	A	H	L	SW	Peso (g)
2500 1/8	R1/8	7,5	19,5	12	9
2500 1/4	R1/4	11	27	14	16
2500 3/8	R3/8	11,5	28	17	21
2500 1/2	R1/2	14	33,5	22	41
2500 3/4	R3/4	16,5	40	27	80
2500 1	R1	19	45,5	34	125

Raccordi Mod. 2501

Niplo Metrico-Cilindrico

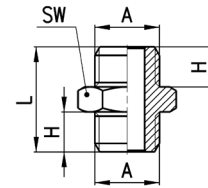

DIMENSIONI

Mod.	A	H	L	SW	Peso (g)
2501 M5	M5	4	11,5	8	2
2501 1/8	G1/8	6	16,5	13	9
2501 1/4	G1/4	8	21	17	15
2501 3/8	G3/8	9	23	19	21
2501 1/2	G1/2	10	25,5	24	35

Raccordi Mod. 2510

Niplo Ridotto Conico

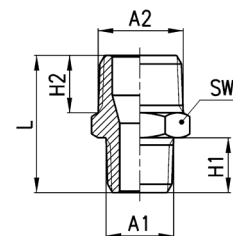

DIMENSIONI

Mod.	A1	A2	H2	H1	L	SW	Peso (g)
2510 1/8-1/4	R1/8	R1/4	11	7,5	23,5	14	14
2510 1/8-3/8	R1/8	R3/8	11,5	7,5	24	17	18
2510 1/4-3/8	R1/4	R3/8	11,5	11	27,5	17	20
2510 1/4-1/2	R1/4	R1/2	14	11	30,5	22	34
2510 3/8-1/2	R3/8	R1/2	14	11,5	31	22	34
2510 1/2-3/4	R1/2	R3/4	16,5	14	37,5	27	67

Raccordi Mod. 2520

Prolunga Riduzione Maschio Conica

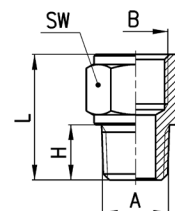

DIMENSIONI						
Mod.	A	B	H	L	SW	Peso (g)
2520 1/8-1/8	R1/8	G1/8	7,5	17,5	13	9
2520 1/8-1/4	R1/8	G1/4	7,5	19	17	15
2520 1/8-3/8	R1/8	G3/8	7,5	20	20	19
2520 1/4-1/4	R1/4	G1/4	11	22,5	17	17
2520 1/4-3/8	R1/4	G3/8	11	23,5	20	21
2520 1/4-1/2	R1/4	G1/2	11	27,5	24	35
2520 3/8-3/8	R3/8	G3/8	11,5	24	20	23
2520 3/8-1/2	R3/8	G1/2	11,5	28	24	37
2520 1/2-1/2	R1/2	G1/2	14	30,5	24	41

Raccordi Mod. 2521

Prolunga Riduzione Metrica-Cilindrica

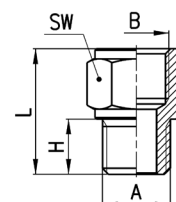

DIMENSIONI						
Mod.	A	B	H	L	SW	Peso (g)
2521 M5-1/8	M5	G1/8	4	14	13	7
2521 1/8-1/8	G1/8	G1/8	6	16	13	8
2521 1/8-1/4	G1/8	G1/4	6	17,5	17	14
2521 1/8-3/8	G1/8	G3/8	6	18,5	20	30
2521 1/4-1/4	G1/4	G1/4	8	19,5	17	16
2521 1/4-3/8	G1/4	G3/8	8	20,5	20	20
2521 1/4-1/2	G1/4	G1/2	8	24,5	24	33
2521 3/8-3/8	G3/8	G3/8	9	21,5	20	22
2521 3/8-1/2	G3/8	G1/2	9	25,5	24	35
2521 1/2-1/2	G1/2	G1/2	10	26,5	24	36

Raccordi Mod. 2511

Nipplo Ridotto Metrico-Cilindrico

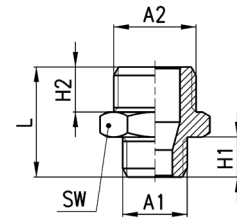

DIMENSIONI

Mod.	A1	A2	H1	H2	L	SW	Peso (g)
2511 M5-1/8	M5	G1/8	4	6	14,5	13	8
2511 1/8-1/4	G1/8	G1/4	6	8	19	17	15
2511 1/8-3/8	G1/8	G3/8	6	9	20	19	19
2511 1/4-3/8	G1/4	G3/8	8	9	22	19	20
2511 1/4-1/2	G1/4	G1/2	8	10	23,5	24	32
2511 3/8-1/2	G3/8	G1/2	9	10	24,5	24	34

Raccordi Mod. 2525

Prolunga Maschio Cilindrica

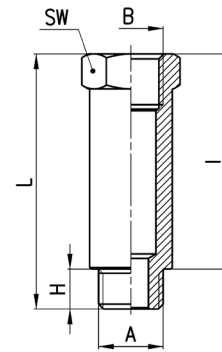

DIMENSIONI

Mod.	A	B	H	I	L	SW	Peso (g)
2525 1/8-16	G1/8	G1/8	6	16	22	13	12
2525 1/8-36	G1/8	G1/8	6	36	42	13	24
2525 1/4-27	G1/4	G1/4	8	27	35	17	30
2525 1/4-43	G1/4	G1/4	8	43	51	17	45

Raccordi Mod. 2530

Riduzione Conica

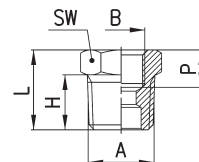

DIMENSIONI

Mod.	A	B	H	P (min)	L	SW	Peso (g)
2530 1/4-1/8	R1/4	G1/8	11	6	16	14	9
2530 3/8-1/8	R3/8	G1/8	11,5	8,5	16,5	17	17
2530 1/2-1/8	R1/2	G1/8	14	9,5	19,5	22	12
2530 3/8-1/4	R3/8	G1/4	11,5	7	16,5	17	34
2530 1/2-1/4	R1/2	G1/4	14	9,5	19,5	22	30
2530 1/2-3/8	R1/2	G3/8	14	8	19,5	22	24
2530 3/4-3/8	R3/4	G3/8	16,5	11,5	23	27	67
2530 3/4-1/2	R3/4	G1/2	16,5	9,5	23,5	27	48
2530 1-1/2	R1	G1/2	19	14	27	34	131

Raccordi Mod. 2531

Riduzione Cilindrica

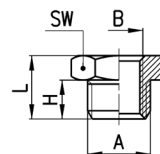

DIMENSIONI

Mod.	A	B	H	L	SW	Peso (g)
2531 1/8-M5	G1/8	M5	6	10,5	13	8 *
2531 1/4-1/8	G1/4	G1/8	8	13	17	11 *
2531 3/8-1/8	G3/8	G1/8	9	14	19	17
2531 3/8-1/4	G3/8	G1/4	9	14	19	12 *
2531 1/2-1/8	G1/2	G1/8	10	15,5	24	32
2531 1/2-1/4	G1/2	G1/4	10	15,5	24	29
2531 1/2-3/8	G1/2	G3/8	10	15,5	24	22 *

* = con filetto passante

Raccordi Mod. 2543

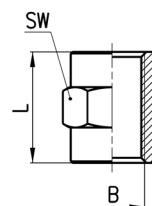
Manicotto

DIMENSIONI

Mod.	B	L	SW	Peso (g)
2543 M5	M5	11	8	3
2543 1/8	G1/8	15	13	8
2543 1/4	G1/4	22	17	19
2543 3/8	G3/8	23	20	19
2543 1/2	G1/2	28	24	29

Raccordi Mod. 2553

Manicotto Riduzione

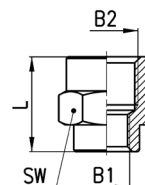
DIMENSIONI

Mod.	B1	B2	L	SW	Peso (g)
2553 M5-1/8	M5	G1/8	13,5	13	7
2553 1/8-1/4	G1/8	G1/4	17	17	18
2553 1/8-3/8	G1/8	G3/8	18	20	18
2553 1/8-1/2	G1/8	G1/2	21,5	24	28
2553 1/4-3/8	G1/4	G3/8	19,5	20	21
2553 1/4-1/2	G1/4	G1/2	23	24	32
2553 3/8-1/2	G3/8	G1/2	24	24	31

Raccordi Mod. 2611
Tappo Maschio Cilindrico

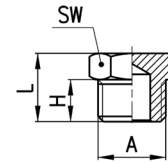

DIMENSIONI					
Mod.	A	H	L	SW	Peso (g)
2611 M5	M5	4	7,5	8	2
2611 1/8	G1/8	6	10,5	13	7
2611 1/4	G1/4	8	13	17	13
2611 3/8	G3/8	9	14	19	18
2611 1/2	G1/2	10	15,5	24	31
2611 1	G1	13	19	38	76

Raccordo Mod. 2610 3/4
Tappo Maschio Conico

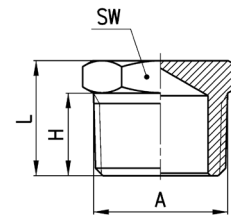

DIMENSIONI					
Mod.	A	H	L	SW	Peso (g)
2610 3/4	R3/4	16,5	23	27	61

Raccordi Mod. 2613
Tappo Femmina Cilindrico

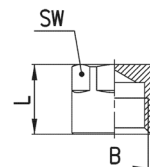

DIMENSIONI				
Mod.	B	L	SW	Peso (g)
2613 1/8	G1/8	11	12	6
2613 1/4	G1/4	13,5	15	13
2613 3/8	G3/8	15,5	18	19
2613 1/2	G1/2	22,5	19	33

Raccordi Mod. 2601

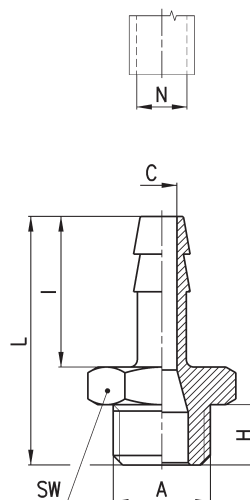
 Portagomma Maschio
Metrico-Cilindrico

DIMENSIONI								
Mod.	N	A	C	H	I	L	SW	Peso (g)
2601 2-M5	2	M5	1,2	4	8	16	8	2
2601 4,5-M5	4	M5	2,5	4	15	23	8	3
2601 7-1/8	7	G1/8	4	6	20	30	12	9
2601 7-1/4	7	G1/4	4	8	20	33	17	16
2601 8-1/8	8	G1/8	5	6	20	30	12	10
2601 9-1/8	9	G1/8	5,5	6	20	30	12	11
2601 9-1/4	9	G1/4	6	8	20	33	17	17
2601 9-3/8	9	G3/8	6	9	20	34	19	21
2601 12-1/4	12	G1/4	8,5	8	20	33	17	20
2601 12-3/8	12	G3/8	9	9	20	34	19	23
2601 12-1/2	12	G1/2	9	10	20	35,5	24	34
2601 17-3/8	17	G3/8	12	9	24	38	19	31
2601 17-1/2	17	G1/2	13	10	24	39,5	24	41

Raccordi Mod. 2013

Gomito Femmina Cilindrico

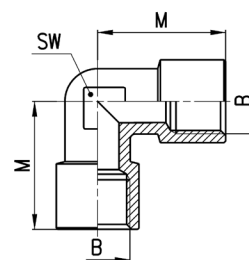

DIMENSIONI				
Mod.	B	M	SW	Peso (g)
2013 1/8	G1/8	19	11	16
2013 1/4	G1/4	23	14	28
2013 3/8	G3/8	25	16	39
2013 1/2	G1/2	31,5	20	69

Raccordi Mod. 2010
Gomito Maschio Conico

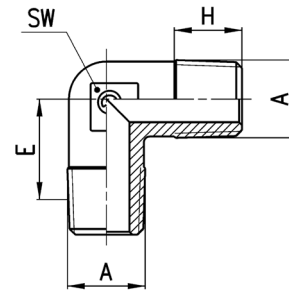

DIMENSIONI					
Mod.	A	E	H	SW	Peso (g)
2010 1/8	R1/8	11,5	7,5	9	10
2010 1/4	R1/4	13,5	11	12	18
2010 3/8	R3/8	15,5	11,5	14	28
2010 1/2	R1/2	16	14	16	47
2010 3/4	R3/4	19	16	25	103
2010 1	R1	23	17	30	183

Raccordi Mod. 2021 e Mod. 2020
Mod. 2021: Gomito Maschio Femmina Metrico
Mod. 2020: Gomito Maschio Femmina Conico

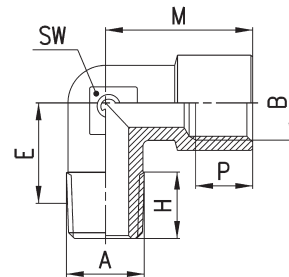

DIMENSIONI								
Mod.	A	B	E	H	M	P (min)	SW	Peso (g)
2021 M5-M5	M5	M5	9	4	10,5	4,5	9	7
2020 1/8-1/8	R1/8	G1/8	11,5	8,5	19	6	11	17
2020 1/4-1/4	R1/4	G1/4	15	11	23	7	13	27
2020 3/8-3/8	R3/8	G3/8	15	11,5	25	8	15	33
2020 1/2-1/2	R1/2	G1/2	17,5	14	31,5	9,5	20	63
2020 3/4-3/4	R3/4	G3/4	19	16	36,5	16,5	25	126
2020 1-1	R1	G1	23	17	45	19	30	209

Raccordi Mod. 2050
T.M.M.F.

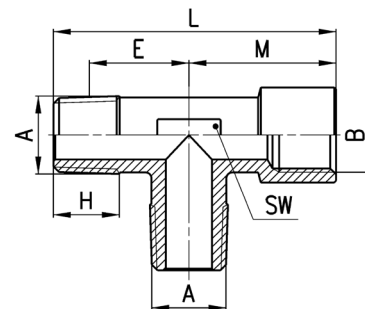

DIMENSIONI								
Mod.	A	B	E	H	L	M	SW	Peso (g)
2050 1/8-1/8	R1/8	G1/8	11,5	8,5	37	19	12	27
2050 1/4-1/4	R1/4	G1/4	15	11	46	23	13	35
2050 3/8-3/8	R3/8	G3/8	15	11,5	48,5	25	16	44
2050 1/2-1/2	R1/2	G1/2	17,5	14	60,5	31,5	20	83

Raccordi Mod. 2060

T.F.M.F.

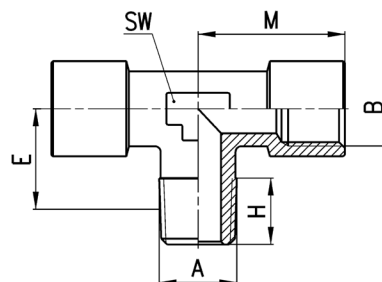

DIMENSIONI							
Mod.	A	B	E	H	M	SW	Peso (g)
2060 1/8-1/8	R1/8	G1/8	11,5	8,5	19	12	22
2060 1/4-1/4	R1/4	G1/4	15	11	23	13	38
2060 3/8-3/8	R3/8	G3/8	15	11,5	25	16	49
2060 1/2-1/2	R1/2	G1/2	17,5	14	31,5	20	89

Raccordi Mod. 2080

T Maschio

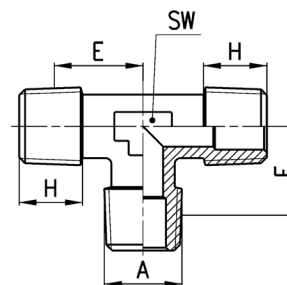

DIMENSIONI					
Mod.	A	E	H	SW	Peso (g)
2080 1/8	R1/8	11,5	7,5	9	14
2080 1/4	R1/4	13,5	11	12	25
2080 3/8	R3/8	15,5	11,5	14	39
2080 1/2	R1/2	16	14	16	82
2080 3/4	R3/4	19	16,2	25	135
2080 1	R1	23	17,5	30	239

Raccordi Mod. 2070

T.M.F.F.

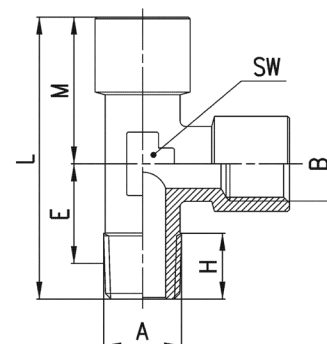

DIMENSIONI								
Mod.	A	B	E	H	L	M	SW	Peso (g)
2070 1/8-1/8	R1/8	G1/8	11,5	8,5	37	19	12	22
2070 1/4-1/4	R1/4	G1/4	15	11	46	23	13	37
2070 3/8-3/8	R3/8	G3/8	15	11,5	48,5	25	16	49
2070 1/2-1/2	R1/2	G1/2	17,5	14	60,5	31,5	20	89

Raccordi Mod. 2090

T.M.F.M.

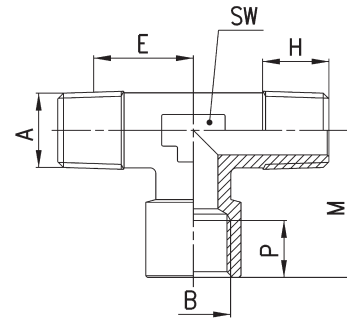

DIMENSIONI								
Mod.	A	B	E	H	M	P	SW	Peso (g)
2090 1/8-1/8	R1/8	G1/8	11,5	8,5	19	6	12	22
2090 1/4-1/4	R1/4	G1/4	15	11	23	7	13	37
2090 3/8-3/8	R3/8	G3/8	15	11,5	25	8	16	44
2090 1/2-1/2	R1/2	G1/2	17,5	14	31,5	9,5	20	83
2090 3/4-3/4	R3/4	G3/4	19	16	36,5	16,5	25	156
2090 1-1	R1	G1	23	17,5	45	19	30	262

Raccordi Mod. 2003

T Femmina

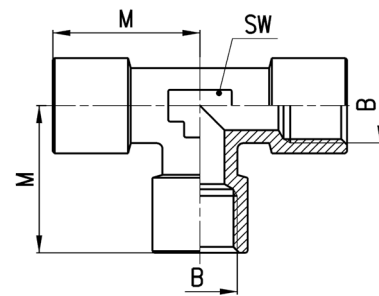

DIMENSIONI				
Mod.	B	M	SW	Peso (g)
2003 1/8	G1/8	19	12	23
2003 1/4	G1/4	23	13	39
2003 3/8	G3/8	25	16	54
2003 1/2	G1/2	31,5	20	97

Raccordi Mod. 2040

Y.F.M.F.

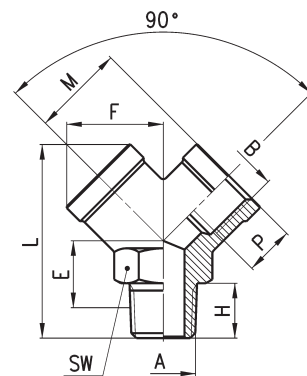

DIMENSIONI										
Mod.	A	B	E	F	H	L	M	P	SW	Peso (g)
2040 1/8-1/8	R1/8	G1/8	9,5	14,5	8	32	14	8	13	22
2040 1/4-1/4	R1/4	G1/4	12	18	11	38	17,5	11	17	38
2040 3/8-3/8	R3/8	G3/8	13,5	20,5	11,5	42,5	19	11,5	20	52
2040 1/2-1/2	R1/2	G1/2	15,5	26,5	14	53	24,5	14	25	110

Raccordi Mod. 2043

Y Femmina

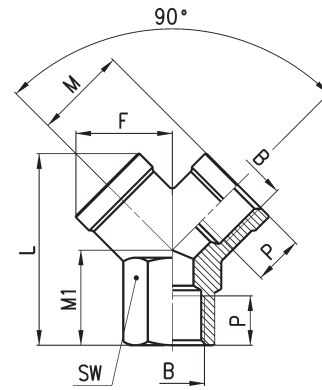
DIMENSIONI

Mod.	B	F	L	M	M1	P	SW	Peso (g)
2043 1/8	G1/8	14,5	26,5	14	12	8	13	18
2043 1/4	G1/4	18	32	17,5	14	11	17	32
2043 3/8	G3/8	20,5	37	19	16	11,5	20	44
2043 1/2	G1/2	26,5	45	24,5	19	14	25	84

Raccordi Mod. 2033

Croce Femmina

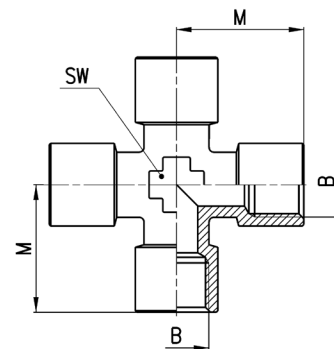
DIMENSIONI

Mod.	B	M	SW	Peso (g)
2033 1/8	G1/8	19	12	27
2033 1/4	G1/4	23	14	51
2033 3/8	G3/8	25	16	70

Raccordi Mod. 2023

Anello Singolo Filettato

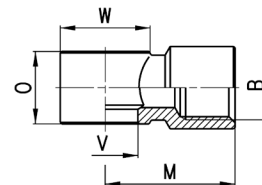
DIMENSIONI

Mod.	B	M	O	V	W	Peso (g)	assemblabile con Mod.
2023 M5-M5	M5	10.5	9	5.1	□ 9	6	1631
2023 M5-M6	M5	10.5	9	5.1	□ 9	6	SCU, SVU, SCO...
2023 1/8-1/8	G1/8	20	14.5	9.8	∅ 14	14	1631, 1635, SCU, SVU, SCO...
2023 1/4-1/4	G1/4	23.5	14.5	13.2	∅ 18	21	1635, SCU, SVU, SCO...
2023 3/8-3/8	G3/8	26.5	14.5	16.7	∅ 21	27	1635, SCU, SVU, SCO...

Accessori Mod. 3033

Blocchetto 4 Vie con fori di fissaggio
Materiale: Alluminio anodizzato

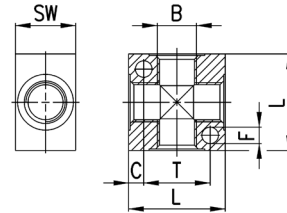
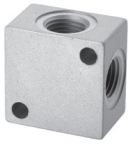

DIMENSIONI							
Mod.	B	C	F	L	T	SW	Peso (g)
3033 1/8	G1/8	4	4,5	25	17	16	18
3033 1/4	G1/4	5	5,5	32	22	20	35
3033 3/8	G3/8	7	5,5	40	26	25	73
3033 1/2	G1/2	8	5,5	50	34	30	137

Accessori Mod. 3043

Collettore con Uscite Contrapposte
Materiale: Alluminio anodizzato

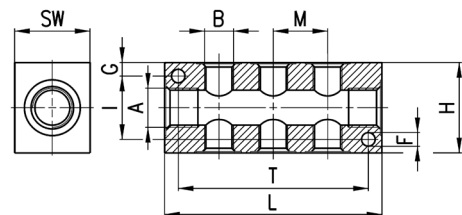

DIMENSIONI												
Mod.	A	USCITE LATERALI DOPPIE	B	F	G	H	I	L	M	T	SW	Peso (g)
3043 1/4-3D-1/8	1/4	3	1/8	4,5	4,5	30	21	72	18	63	20	85
3043 1/4-4D-1/8	1/4	4	1/8	4,5	4,5	30	21	90	18	81	20	107
3043 1/4-5D-1/8	1/4	5	1/8	4,5	4,5	30	21	108	18	99	20	128
3043 1/4-6D-1/8	1/4	6	1/8	4,5	4,5	30	21	126	18	117	20	151
3043 3/8-3D-1/4	3/8	3	1/4	5,5	6	40	28	92	24	75	25	177
3043 3/8-4D-1/4	3/8	4	1/4	5,5	6	40	28	116	24	99	25	224
3043 3/8-5D-1/4	3/8	5	1/4	5,5	6	40	28	140	24	123	25	270
3043 3/8-6D-1/4	3/8	6	1/4	5,5	6	40	28	164	24	147	25	315
3043 1/2-3D-3/8	1/2	3	3/8	5,5	6,5	50	37	104	26	85	30	287
3043 1/2-4D-3/8	1/2	4	3/8	5,5	6,5	50	37	130	26	111	30	356
3043 1/2-5D-3/8	1/2	5	3/8	5,5	6,5	50	37	156	26	137	30	427
3043 1/2-6D-3/8	1/2	6	3/8	5,5	6,5	50	37	182	26	163	30	495

Accessori Mod. 3053

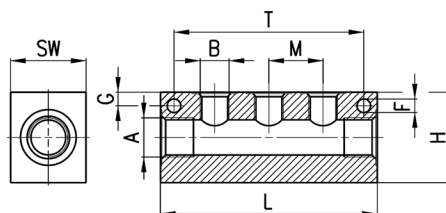
 Collettore con Uscite Laterali
 Materiale: Alluminio anodizzato

DIMENSIONI											
Mod.	A	USCITE LATERALI SINGOLE	B	F	G	H	L	M	T	SW	Peso (g)
3053 1/4-3L-1/8	1/4	3	1/8	4,5	4,5	30	72	18	63	20	92
3053 1/4-4L-1/8	1/4	4	1/8	4,5	4,5	30	90	18	81	20	116
3053 1/4-5L-1/8	1/4	5	1/8	4,5	4,5	30	108	18	99	20	140
3053 1/4-6L-1/8	1/4	6	1/8	4,5	4,5	30	126	18	117	20	164
3053 3/8-3L-1/4	3/8	3	1/4	5,5	6	40	92	24	75	25	191
3053 3/8-4L-1/4	3/8	4	1/4	5,5	6	40	116	24	99	25	243
3053 3/8-5L-1/4	3/8	5	1/4	5,5	6	40	140	24	123	25	294
3053 3/8-6L-1/4	3/8	6	1/4	5,5	6	40	164	24	147	25	345
3053 1/2-3L-3/8	1/2	3	3/8	5,5	6,5	50	104	26	85	30	313
3053 1/2-4L-3/8	1/2	4	3/8	5,5	6,5	50	130	26	111	30	395
3053 1/2-5L-3/8	1/2	5	3/8	5,5	6,5	50	156	26	137	30	474
3053 1/2-6L-3/8	1/2	6	3/8	5,5	6,5	50	182	26	163	30	551

Raccordi accessori Serie X2000 in Acciaio Inox 316L

 Novità

Filetti dei raccordi: cilindrici (G1/8, G1/4, G3/8, G1/2, G3/4),
conici (R1/8, R1/4, R3/8, R1/2, R3/4)



I raccordi Serie X2000 in acciaio inossidabile AISI 316L sono disponibili in diverse configurazioni per soddisfare le richieste del cliente in termini di affidabilità e adattabilità alle proprie esigenze.

Possono essere utilizzati all'interno di impianti pneumatici, oleodinamici (a bassa pressione), idropneumatici e trovano impiego in diversi settori tra cui quello alimentare, quello chimico e quello medicale.

4

COLLEGAMENTO

CARATTERISTICHE GENERALI

Materiale	corpo = acciaio INOX 316L guarnizioni = FKM
Filettature	GAS conico ISO 7 (BSPT) GAS cilindrico ISO 228 (BSP)
Pressione	40 bar
Fluido	Aria compressa ed altri fluidi a bassa pressione.
Temperatura	-40°C + 120°C

Raccordi accessori

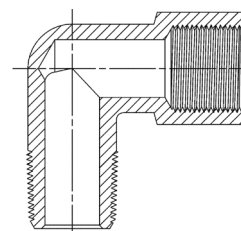

Raccordi Mod. X2500

Niplo Conico

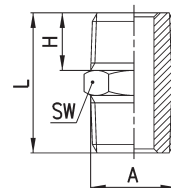
DIMENSIONI

Mod.	A	H	L	SW	Peso (g)
X2500 1/8	R1/8	10	25	12	11
X2500 1/4	R1/4	12	29.5	14	19
X2500 3/8	R3/8	12	30	17	25
X2500 1/2	R1/2	13	32.5	22	43
X2500 3/4	R3/4	15	37	27	77

Raccordi Mod. X2510

Niplo Ridotto Conico

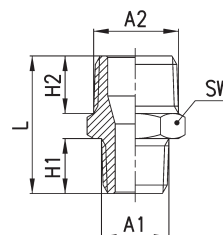
DIMENSIONI

Mod.	A1	A2	H2	H1	L	SW	Peso (g)
X2510 1/8-1/4	R1/8	R1/4	12	10	27.5	14	16
X2510 1/8-3/8	R1/8	R3/8	12	10	28	17	21
X2510 1/4-3/8	R1/4	R3/8	12	12	30	17	24
X2510 1/4-1/2	R1/4	R1/2	13	12	31.5	22	38
X2510 3/8-1/2	R3/8	R1/2	13	12	31.5	22	39
X2510 1/2-3/4	R1/2	R3/4	15	13	35	27	65

Raccordi Mod. X2530

Riduzione Conica

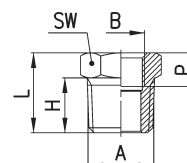
DIMENSIONI

Mod.	A	B	H	P (min)	L	SW	Peso (g)
X2530 1/4-1/8	R1/4	G1/8	12	8	17.5	14	12
X2530 3/8-1/8	R3/8	G1/8	12	8.5	18	17	19
X2530 3/8-1/4	R3/8	G1/4	12	9.5	18	17	16
X2530 1/2-1/4	R1/2	G1/4	13	10.5	19.5	22	33
X2530 1/2-3/8	R1/2	G3/8	13	12.5	19.5	22	27
X2530 3/4-1/2	R3/4	G1/2	15	13	22	27	48

Raccordi Mod. X2543

Manicotto

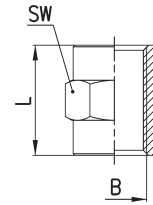

DIMENSIONI

Mod.	B	L	SW	Peso (g)
X2543 1/8	G1/8	14.5	14	11
X2543 1/4	G1/4	20	17	19
X2543 3/8	G3/8	21.5	22	34
X2543 1/2	G1/2	27	27	63
X2543 3/4	G3/4	28	32	77

Raccordi Mod. X2612

Tappo Maschio Cilindrico con tenuta O-ring

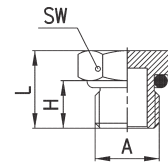

DIMENSIONI

Mod.	A	H	L	SW	Peso (g)
X2612 1/8	G1/8	6	11.5	14	10
X2612 1/4	G1/4	6.5	12.5	17	15
X2612 3/8	G3/8	6.5	13	22	25
X2612 1/2	G1/2	9.5	16.5	27	40
X2612 3/4	G3/4	13	24	36	110

Raccordi Mod. X2013

Gomito Femmina Cilindrico

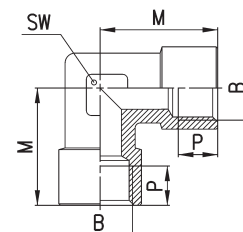

DIMENSIONI

Mod.	B	M	P (min)	SW	Peso (g)
X2013 1/8	G1/8	20	8	12	30
X2013 1/4	G1/4	23	10	14	40
X2013 3/8	G3/8	29	12.5	18	70
X2013 1/2	G1/2	33	13	24	115
X2013 3/4	G3/4	36	15	28	170

Raccordi Mod. X2020
Gomito Maschio Femmina Cilindrico

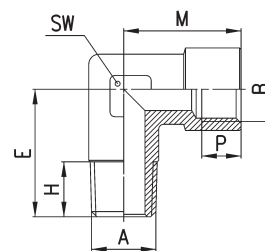

DIMENSIONI								
Mod.	A	B	E	H	M	P (min)	SW	Peso (g)
X2020 1/8-1/8	R1/8	G1/8	20	10	20	8	12	25
X2020 1/4-1/4	R1/4	G1/4	23	11.5	23	10	14	35
X2020 3/8-3/8	R3/8	G3/8	29	12	29	12.5	18	65
X2020 1/2-1/2	R1/2	G1/2	33	13	33	13	24	115
X2020 3/4-3/4	R3/4	G3/4	36	15	36	15	28	170

Raccordi Mod. X2060
T.F.M.F.

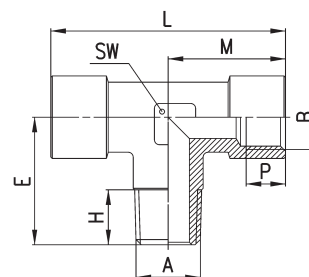

DIMENSIONI									
Mod.	A	B	E	H	M	L	P (min)	SW	Peso (g)
X2060 1/8-1/8	R1/8	G1/8	20	10	20	40	8	12	30
X2060 1/4-1/4	R1/4	G1/4	23	11.5	23	46	10	14	45
X2060 3/8-3/8	R3/8	G3/8	29	12	29	58	12.5	18	85
X2060 1/2-1/2	R1/2	G1/2	33	13	33	66	13	24	150
X2060 3/4-3/4	R3/4	G3/4	36	15	36	72	15	28	220

Raccordi Mod. X2003
T.F.M.F.

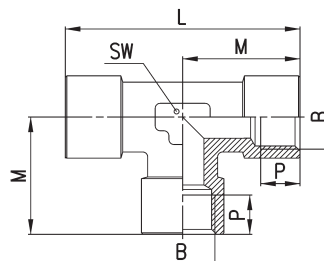

DIMENSIONI						
Mod.	B	M	L	P (min)	SW	Peso (g)
X2003 1/8	G1/8	20	40	8	12	35
X2003 1/4	G1/4	23	46	10	14	50
X2003 3/8	G3/8	29	58	12.5	18	90
X2003 1/2	G1/2	33	66	13	24	155
X2003 3/4	G3/4	36	72	15	28	225

Tubi, spirali e accessori

Tubi: PVC rinforzato, Poliammide PA12, Poliesteri Hytrel, Polietilene, PU

Diametri: 4/2, 5/3, 6/4, 8/6, 10/8, 12/10, 15/12,5 mm



Camozzi propone una gamma di tubi e spirali con caratteristiche specifiche che li rendono adatti alle molteplici esigenze tecniche degli utilizzatori finali. Grazie all'impiego di materie prime di alta qualità e con un basso peso specifico, questi prodotti hanno ingombri e peso molto ridotti. Hanno inoltre un'ottima resistenza a sollecitazioni, flessioni alternate e vibrazioni.

L'elevata specularità delle superfici interne di passaggio dei fluidi (rugosità 0,6 micron circa) permette di ridurre al minimo le perdite di carico e di ottenere portate notevolmente più elevate a parità di diametro. I tecnopolimeri impiegati sono particolarmente resistenti all'invecchiamento, garantendo una lunghissima durata nel tempo.

Tubi Mod. PV

Tubi in PVC rinforzato

Colore standard: Azzurro



Mod.	D/d	Pressione max a 20°C (bar)	Peso (g/m)	Raggio min. di curv. (mm)	Matassa (m)
PV 6/4	6/4	40	22	50	50
PV 8/6	8/6	38	30	60	50
PV 10/8	10/8	30	40	65	50
PV 12/10	12/10	24	56	80	50
PV 15/12,5	15/12.5	18	70	90	50

Tubi Mod. TRN

Tubi in poliammide PA12

Colore standard: neutro

Colori disponibili su richiesta:

Blu - Rosso - Verde - Nero - Giallo



Mod.	D/d	Pressione max a 23°C (bar)	Peso (g/m)	Raggio min. di curv. (mm)	Matassa (m)
TRN 4/2	4/2	44	9.7	16	100
TRN 5/3	5/3	33	12.9	20	100
TRN 6/4	6/4	28	16.2	30	100
TRN 8/6	8/6	20	22.6	40	100
TRN 10/8	10/8	16	29.1	60	50
TRN 12/10	12/10	12	35.6	85	50

Tubi Mod. TRH

Tubi in poliestere Hytrel

Colore standard: azzurro

Colori disponibili su richiesta:

Rosso - Verde - Nero - Giallo - Bianco



Mod.	D/d	Pressione max a 23°C (bar)	Peso (g/m)	Raggio min. di curv. (mm)	Matassa (m)
TRH 4/2-Z	4/2	32	11.5	16	100
TRH 5/3-Z	5/3	27	15.3	25	100
TRH 6/4-Z	6/4	21	19.2	35	100
TRH 8/6-Z	8/6	15	26.8	65	100
TRH 10/8-Z	10/8	12	34.5	100	50
TRH 12/10-Z	12/10	10	42.1	125	50

Tubi Mod. TPE

Tubi in Polietilene a bassa densità

Colore standard: neutro
Colori disponibili su richiesta: Blu



Mod.	D/d	Pressione max a 23°C (bar)	Peso (g/m)	Raggio min di curv. (mm)	Matassa (m)
TPE 5/3	5/3	17	11.3	23	100
TPE 6/4	6/4	13	14.1	32	100
TPE 8/6	8/6	10	19.8	43	100
TPE 10/8	10/8	7	25.4	76	100

Tubo Mod. TPC

Tubi in Poliuretano 98 Shore

Colore standard: Grigio RAL 7012



Mod.	D/d	Pressione max a 23°C (bar)	Peso (g/m)	Raggio min. di curv. (mm)	Matassa (m)
TPC 4/2	4/2	19	11.5	11	100
TPC 6/4	6/4	13	19.2	18	100
TPC 8/6	8/6	9	26.8	35	100
TPC 10/8	10/8	7	34.5	45	100
TPC 12/8	12/8	9	76.6	50	100

Tubi Mod. TSP

Spirale in Rilsan (PA 11)

Colore standard: Blu
Altri colori disponibili su richiesta



Mod.	D/d	Pressione max a 20°C (bar)	Ø esterno	Lunghezza chiusa (mm)	Lunghezza aperta (mm)
TSP 6/4	6/4	20	64	1000	15000
TSP 8/6	8/6	14	86	1000	15000
TSP 10/8	10/8	11	102	1050	15000
TSP 12/10	12/10	9	126	1050	15000

Morsettiere Mod. MPL

Morsettiera porta tubi in plastica

Colore: Blu

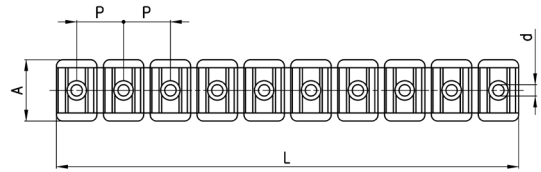

Mod.	Ø Tubo	L	A	d	P	N° posizioni
MPL-4	4	114	19	2.8	11.7	10
MPL-6	6	114	19	2.8	11.7	10
MPL-8	8	143	19	3.8	14.6	10
MPL-10	10	172	19	5.3	17.4	10
MPL-12	12	162	19	5.3	20.5	8
MPL-14	14	180	19	5.3	22.5	8

Pinze Mod. PNZ

Pinza tagliatubo piccola e grande

Le lame di ricambio sono ordinabili separatamente



Mod.	
PNZ-12	può tagliare tubi con Ø fino a 12 mm
PNZ-25	può tagliare tubi con Ø fino a 25 mm

Pinza tagliatubi in plastica Mod. PNZP-12

Mod.	
PNZP-12	può tagliare tubi con Ø fino a 12 mm

